

Upper control arm designed for classic Ford Mustang models. Made from durable PA9 aluminum alloy, it ensures excellent rigidity and wear resistance. The surface is black anodized, enhancing its aesthetic appeal while providing additional protection against corrosion and mechanical damage. This product is part of our proprietary Classic BoltOn and Trapez Billet suspension systems.

**LIGHTWEIGHT AND DURABLE PA9 ALUMINUM**

**PRECISE SUSPENSION GEOMETRY  
ADJUSTMENT CAPABILITY**

**CNC MACHINING**

**DESIGN DEVELOPED USING A 3D CAD  
ENVIRONMENT**

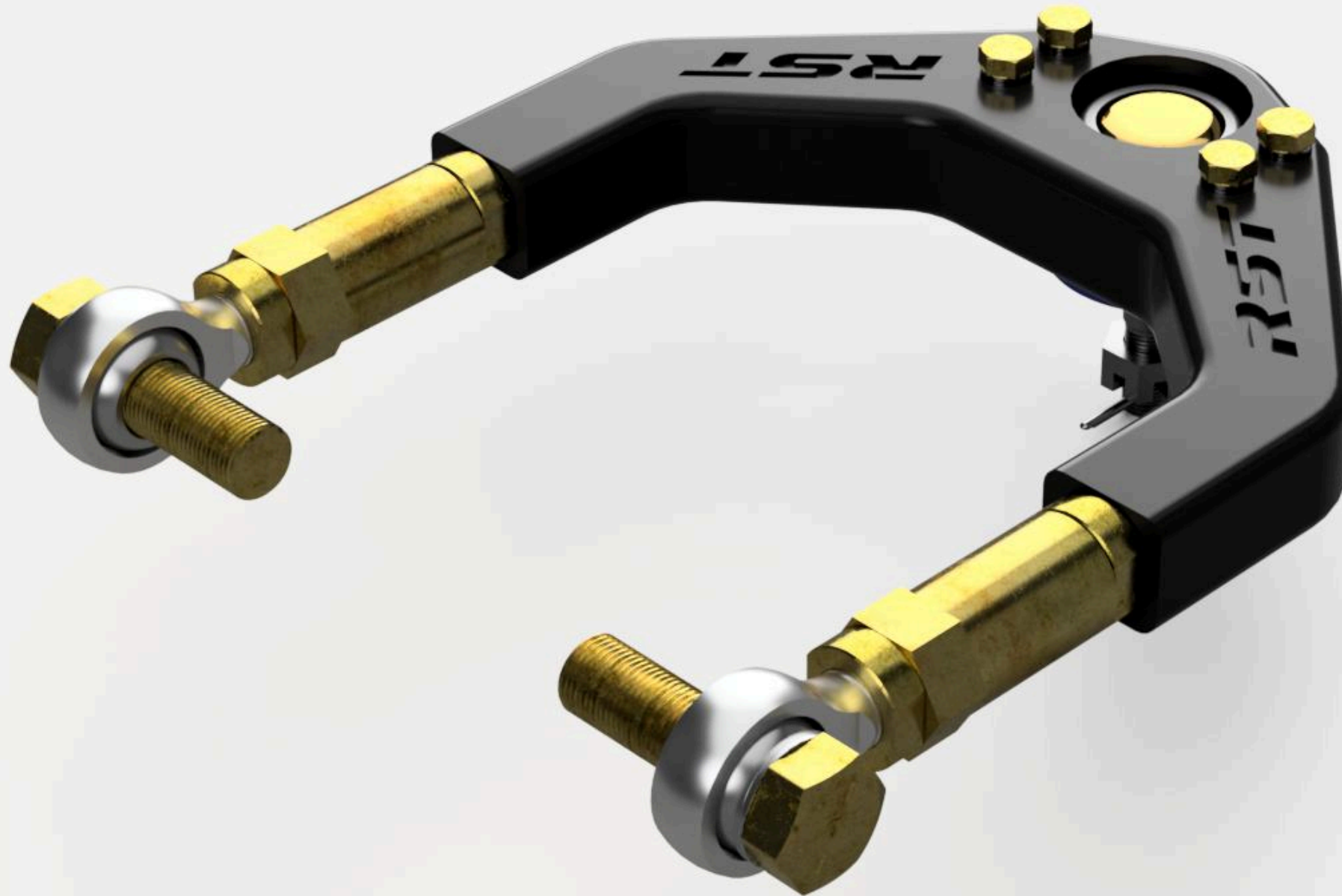

#### PRODUCT DESCRIPTION

The control arm body is made from high-strength PA9 aluminum, CNC-machined to ensure high production consistency. Designed in a CAD environment, the project allowed for precise refinement of even the smallest details. The control arm's construction enables the upper ball joint to be seated in a precisely machined socket, eliminating any possible play. Anodizing the body provides excellent resistance to corrosion and mechanical damage.

Thanks to turnbuckles made from 40HMT steel and uniball spherical bearings made from chrome-molybdenum steel, precise suspension geometry adjustment is possible. The reduced weight compared to original suspension components ensures better handling and quicker steering response. The fully adjustable suspension gives the vehicle a new character - delivering modern performance while preserving the spirit of classic motoring.

#### KEY PRODUCT FEATURES

- Lower weight compared to the original component
- Design verified through FEA (Finite Element Analysis)
- Project developed based on a 3D scan of the original bodywork



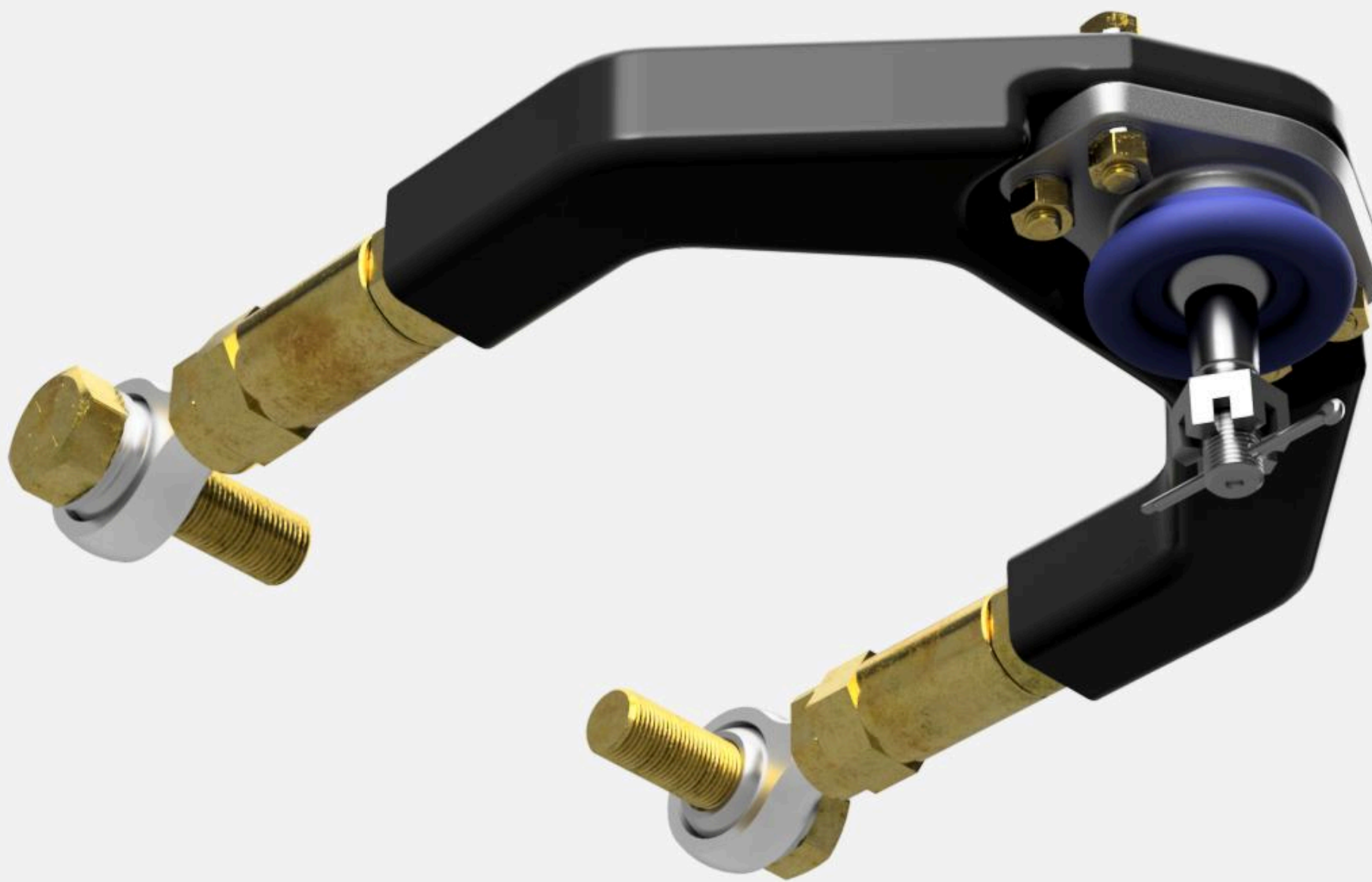

**THE KIT INCLUDES**

- CNC-machined upper control arm body
- Spherical bearings (uniballs) (2 pcs.)
- Turnbuckle bolts (2 pcs.)
- Mounting kit

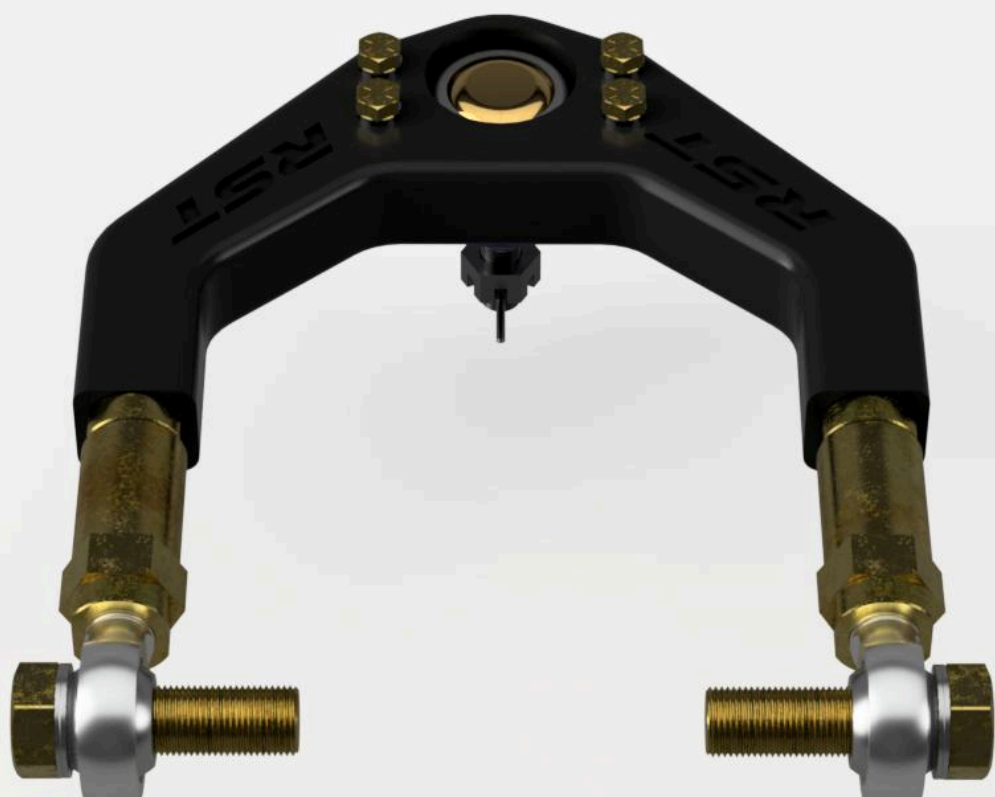
**APPLICATION**

This product is compatible with the following Ford Mustang model years:

- Ford Mustang Fastback 1964/5-1966
- Ford Mustang Fastback 1967-1968
- Ford Mustang Coupe 1964/5-1966
- Ford Mustang Coupe 1967-1968
- Ford Mustang Convertible 1964/5-1966
- Ford Mustang Convertible 1967-1968



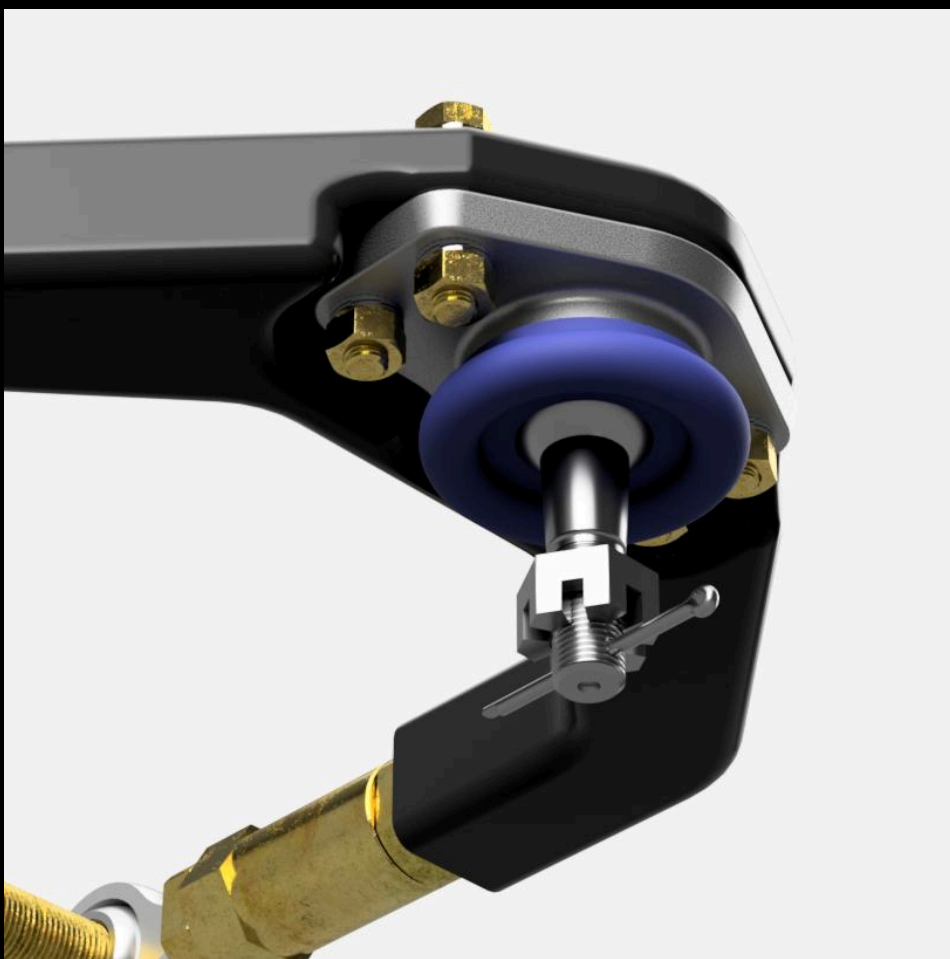

#### INSTALLATION INSTRUCTIONS

Technical data sheet

#### DIFFICULTY LEVEL

Advanced - installing this product requires extensive specialist knowledge.

#### NOTES

\*Before purchasing, ensure that the product is compatible with your vehicle

#### CONTACT

+48 572 323 272

biuro@restomotive.eu

[www.restomotive.eu](http://www.restomotive.eu)