



The front suspension strut brace is a solid reinforcement that increases the rigidity of the body in classic Mustangs. It improves steering precision, reduces shock absorber deformation, and enhances stability during dynamic driving.

Made from durable steel, it ensures a perfect fit to the original mounting points, maintaining the classic look and character of the vehicle. An ideal solution for sports driving enthusiasts and the restoration of old-school muscle cars.

IMPROVED STEERING PRECISION

STIFFENING OF THE STRUT STRUCTURE

REDUCED BODY DEFORMATION

DESIGN BASED ON 3D SCANNING



#### PRODUCT DESCRIPTION

The construction of the strut is based on sheet metal and aluminum elements made using CNC technology through laser cutting. To protect against corrosion, these elements have undergone a zinc plating process in a gold color.

The arms are made using CNC milling from 7075 aluminum. To connect the flanges of the cups with the arms, uniballs made of chromium-molybdenum steel were used.



#### MAIN FEATURES OF THE PRODUCT

- Adjustment: The product includes a mechanism of turnbuckle made of billet aluminum for adjusting the spacing between the dashboard/cups, with an adjustment range of (0-40mm).
- Durable construction: Knowing the design flaws of classic Mustangs, we developed reinforcements that effectively stiffen the space in the engine compartment. The design has been tested in a finite element analysis (FEA) environment to simulate the forces occurring in the suspension.
- Precise fit: Thanks to the ability to 3D scan original specimens and 3D modeling, the strut features perfect accuracy and fit to the car's structure.



**THE SET INCLUDES:**

- Cup mounts (left side)
- Cup mounts (right side)
- Upper cowl mount (left side)
- Upper cowl mount (right side)
- Strut arm (left side)
- Strut arm (right side)
- Machined central cowl connector
- Mounting kit

**APPLICATION:**

This product will fit the following model years of Ford Mustang:

- 1965 Fastback, Coupe, Convertible
- 1966 Fastback, Coupe, Convertible
- 1967 Fastback, Coupe, Convertible
- 1968 Fastback, Coupe, Convertible
- 1969 Fastback, Coupe, Convertible
- 1970 Fastback, Coupe, Convertible





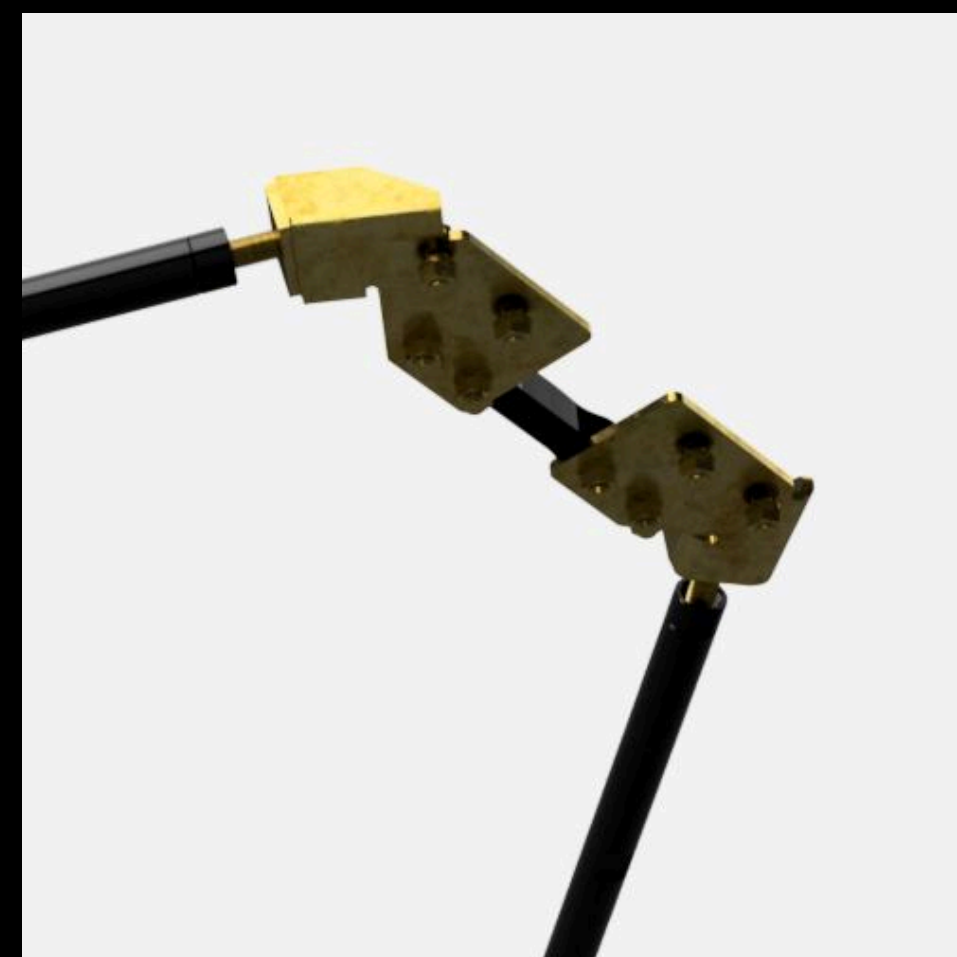
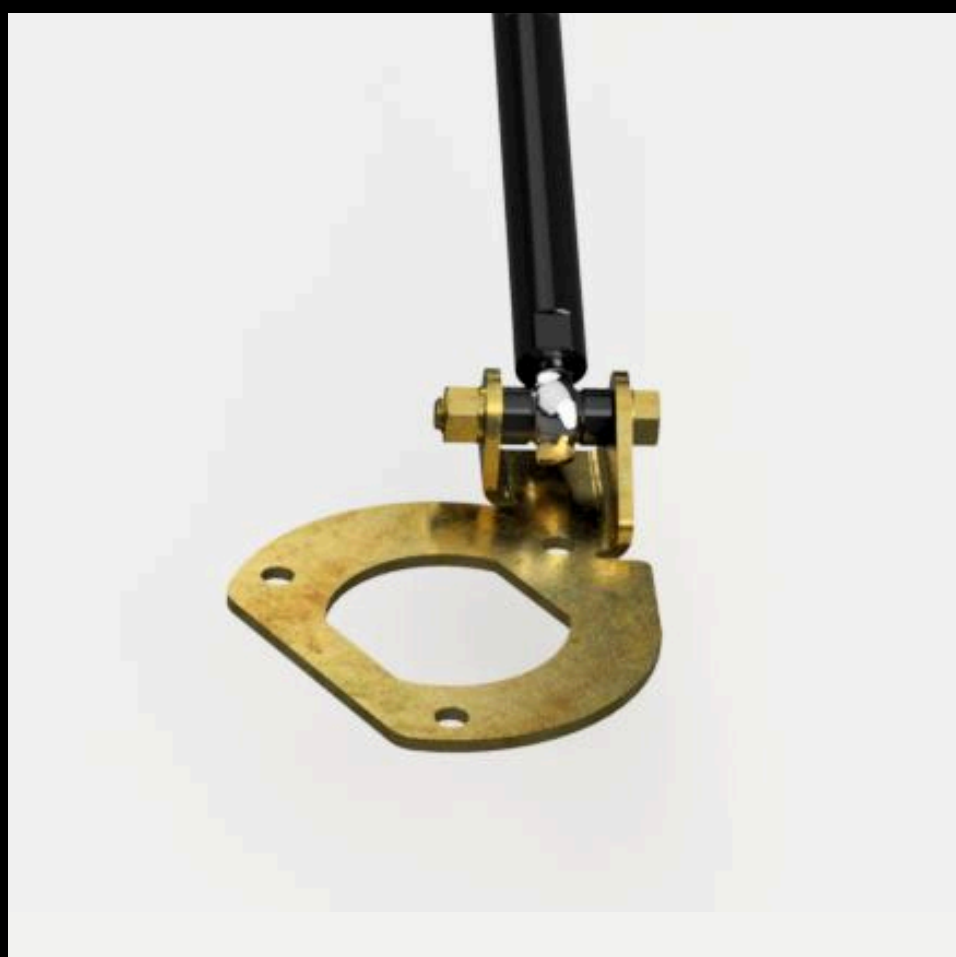

**INSTALLATION INSTRUCTIONS:**

Technical data sheet

**DIFFICULTY LEVEL:**

Intermediate - automotive fans with minimal knowledge will be able to install the purchased part.

**NOTES:**

\*Before purchasing, make sure that the product fits your car.

**CONTACT:**

+48 572 323 272

biuro@restomotive.eu

[www.restomotive.eu](http://www.restomotive.eu)